

Meeting

Licensing SUB-COMMITTEE

Date and time

Tuesday 10TH JANUARY, 2023

At 10.30 AM

Venue

Committee ROOM 3, HENDON TOWN HALL, THE BURROUGHS, LONDON NW4 4BQ

To: Members of Licensing SUB-COMMITTEE (quorum 3)

Val Duschinsky
Claire Farrier
Zakia Zubairi
Barry Rawlings

Danny Rich
Eva Greenspan
Anne Hutton
Andrea Bilbow OBE

Philip Cohen
Alison Cornelius
Jennifer Grocock
Richard Barnes

In line with the Constitution's Public Participation and Engagement Rules, requests to submit public questions or comments must be submitted by 10AM on the third working day before the date of the committee meeting. Therefore, the deadline for this meeting is Thursday, 5 January 2023 at 10AM. Requests must be submitted to Governance Service governanceservice@barnet.gov.uk

You are requested to attend the above meeting for which an agenda is attached.

Andrew Charlwood – Head of Governance

Governance Service contact: Governance Service governanceservice@barnet.gov.uk

Media Relations Contact: Tristan Garrick 020 8359 2454 Tristan.Garrick@Barnet.gov.uk

Assurance Group

Please consider the environment before printing.

Recording of Meetings

Members of the public have the right to film, record or photograph public meetings. You may be asked to stop filming, photographing or recording a meeting if the Chair feels that the activity is disrupting the meeting. The meeting may be broadcast live or recorded for later transmission by the Council. Recordings may be available live or viewed for twelve months afterwards.

If you are attending the meeting either in person or online, you understand that you may be picked up in recordings made by the public or the Council.

Order of Business

Item No	Title of Report	Pages
1.	Appointment of Chairman	
1.	Absence of Members (If any)	
1.	Declaration of Members' Disclosable Pecuniary interests and Non Pecuniary interests (If any)	
1.	Licensing Sub-Committee Hearing Procedure	5 - 8
1.	Report of Trading Standards & Licensing Manager - Flavours, 218 Burnt Oak Broadway, Edgware HA8 0AP	9 - 66
1.	Motion to exclude the Press and Public	
1.	Deliberation by the Sub-Committee in Private Session	
1.	Re-admission of the Press and Public: Announcement of the decision of the Sub-Committee	
1.	Any other Item(s) the Chairman decides are urgent	

Facilities for people with disabilities

Hendon Town Hall has access for wheelchair users including lifts and toilets. If you wish to let us know in advance that you will be attending the meeting, please telephone Governance Service governanceservice@barnet.gov.uk. People with hearing difficulties who have a text phone, may telephone our minicom number on 020 8203 8942. All of our Committee Rooms also have induction loops.

Fire/emergency evacuation procedure

If the fire alarm sounds continuously, or if you are instructed to do so, you must leave the building by the nearest available exit. You will be directed to the nearest exit by uniformed custodians. It is vital you follow their instructions.

You should proceed calmly; do not run and do not use the lifts.

Do not stop to collect personal belongings

Once you are outside, please do not wait immediately next to the building, but move some

distance away and await further instructions.

Do not re-enter the building until told to do so.

This page is intentionally left blank

LONDON BOROUGH OF BARNET

LICENSING SUB COMMITTEE

HEARINGS PROCEDURE

AGENDA ITEM 4

General points

The following procedure is based on Regulations made by the Secretary of State under the Licensing Act 2003 (“the Hearings Regulations”) which may be viewed or downloaded from the website of the Department for Culture, Media and Sport by following links from www.culture.gov.uk

The procedure is intended as a general framework to ensure natural justice and a fair hearing. The conduct of individual hearings may vary slightly according to circumstances and the discretion of the Chairman. In all cases, however, this general framework will be followed.

The procedure allows each party a maximum period of 5 minutes in which to present their case (Regulations 16 & 24). At the end of the time allowed, the Chairman will terminate the presentation and the hearing will proceed in the form of a discussion led by the authority to explore points of dispute. The discussion will not be timed.

The procedure is subject to periodic review and amendment to reflect best practice and relevant legislative changes. An updated version of this procedure is published as soon as possible following any such amendments.

Governance Officer

- To seek nominations for Chairman
- Elect Chairman
- Hand over to the Chairman

Chairman

- Introduces him/herself and Members of the Committee, and outlines their roles.
- Introduces Licensing, Legal and Governance Officer.
- Explains that Legal and Governance Officers will be present during the Committee’s deliberations to advise only, and that the Licensing Officer will be excluded from deliberations.
- Asks parties present to introduce themselves.
- Outlines procedure to be followed.
- Asks all parties to confirm their understanding of the procedure.
- Clarifies any aspect(s) of the procedure where any parties are uncertain or asks Legal or Governance Officer as appropriate to clarify.

Governance Officer

- Informs Committee of absent parties.
- Details persons whom a party is seeking permission to represent them at hearing.
- Panel confer regarding permission.
- Chairman announces decision regarding permission.

Licensing Officer presents the report to the Committee

- Is a statement of the facts including details of the application and operating schedule, relevant policy details, detail representations made, a chronology of events and highlights the points on which the Authority requires clarification.

Applicant

- Presents opening submissions and clarifies points raised by Authority in notice of hearing. Time allowed 5 mins.

Other parties

- Presents opening submissions either in person or by spokes person Time allowed 5 mins per interested party.

Note regarding use of video evidence

Video evidence must be in DVD format and will form part of the relevant party's five minutes opening submission. Any party wishing to use video evidence must submit a copy to the Authority along with sufficient, identical extra copies to serve on all the opposing parties – i.e. if the applicant is submitting it, there must be enough copies for all parties making representations and if a party making representations is submitting it there must be a copy for the applicant. The recording must be edited down to the highlights, containing only relevant matter which relates to the written representation previously submitted. In addition, a description of how, when and where the video was recorded and what it contains must be submitted. These must be supplied to the Authority at least five working days before the hearing.

Members question Licensing Officer on Policy

Discussion

Chairman leads a discussion concentrating on points of dispute:

Chairman asks Applicant what he disputes in other parties' submissions, and asks other parties to comment.

Chairman proceeds through all objectors dealing with all matters of contention.

When Chairman feels all matters have been thoroughly discussed and all parties have been given a fair and equal opportunity to comment and make representations, she/he closes discussion.

Determination

There are two procedures depending on whether or not determination is to be made at the end of the Hearing or within five working days of the Hearing. This later announcement of determination is permitted in terms of the Legislation for certain types of applications.

Chairman informs all present that the Committee will deliberate, that Legal and Governance Officer will remain to advise but will not be part of decision-making process, and that all others must leave (under Regulation 14).

- Parties, apart from Legal and Governance Officer, leave the room.
- The Committee deliberates, with advice as required from Legal and Governance Officer, and reaches a conclusion. The Legal officer may assist, as required, in formulating the wording of the determination.
- Parties return.
- Chairman reads out determination, and advises it will be sent in ⁶

writing to all parties.

- Opportunity for determination to be clarified by any interested party who is unclear.
- Chairman gives advice about appealing against the determination.
- Chairman thanks all for attending and closes the meeting.

...Within five working days of the hearing

- Chairman explains requirement to determine the Hearing within five working days, and advises that the Committee will proceed to deliberate and announce the determination within that time.
- During deliberations, Legal and Governance Officers remain to advise on law and procedure as required. The Legal Officer may assist, as required, in formulating the wording of the determination. The Licensing Officer plays no part in the determination and withdraws for this part of the proceedings.
- Chairman advises all parties that they will receive written notification of the determination within five working days of the Hearing date, together with general information on how to appeal against the determination.
- Chairman thanks all parties for attending and invites the applicant, objector(s), other party(ies) and the Licensing Officer to leave.

Information on Appealing against the decision

You may at any time before the expiration of a period of 21 days from notification appeal to Willesden Magistrates' Court, 448 High Road London England NW10 2DZ (Telephone 020 8955 0555, DX 110850 Willesden 2) by way of Complaint for an Order. The Court may either dismiss the appeal, substitute for the decision appealed against any other decision which could have been made by the Licensing Authority or remit the case to the Licensing Authority to dispose of it in accordance with the directions of the court, and can make such order as to costs as it thinks fit.

This page is intentionally left blank



Licensing Sub-Committee

AGENDA ITEM 5

10th January 2023

Title

**Flavours
218 Burnt Oak Broadway
Edgware HA8 0AP**

Report of

Trading Standards & Licensing Manager

Wards

Burnt oak

Status

Public

Urgent

N/A

Key

No

Enclosures

*Report of the Licensing Officer
Annex 1 – Original Licence
Annex 2 – Application Form and plan
Annex 3 – Conditions agreed with the Police
Annex 4 - Representation
Annex 5 – Matters for Decision*

Officer Contact Details

Summary

This report asks the Sub-Committee to consider an application for a Variation of a Premises Licence, under section 34 of the Licensing Act 2003

Officers Recommendations

1. This report asks the Sub-Committee to consider an application for a Variation of a Premises Licence, under section 34 of the Licensing Act 2003 for Flavours 218 Burnt Oak Broadway Edgware HA8 0AP

1. WHY THIS REPORT IS NEEDED

- 1.1 The licensing authority having received valid representations against the application for a variation of a premises licence is expected to hold a hearing to consider those representations. The application can be determined by the licensing authority without a hearing in certain circumstances.

2. REASONS FOR RECOMMENDATIONS

- 2.1 Where a relevant representation is submitted under Section.35(3) of the Licencing Act 2003 the authority must hold a hearing to consider such representations, unless the authority, the applicant and each person who has made such representations agree that a hearing is unnecessary. Relevant representations mean those which are about the likely effect of the grant of the application on the promotion of the licensing objectives, and have been made in time, not withdrawn, and in the case of representations made by a person (other than a responsible authority), are not considered by the licensing authority to be frivolous or vexatious.

3. ALTERNATIVE OPTIONS CONSIDERED AND NOT RECOMMENDED

- 3.1 The Licensing Sub-Committee is required to give appropriate weight to the representations (including supporting information) presented by all the parties, the Guidance issued pursuant to section 182 of the Licensing Act 2003, the Council's statement of licensing policy and the steps that are appropriate to promote the four licensing objectives.

Having considered those relevant matters, the Licensing Sub-Committee is required to take such of the following steps (if any) as it considers appropriate for the promotion of the licensing objectives.

The steps are—

- (a) to modify the conditions of the licence;
- (b) to reject the whole or part of the application;

and for this purpose the conditions of the licence are modified if any of them is altered or omitted or any new condition is added.

- (a) To vary the licence subject to—

- (i) conditions that are consistent with the operating schedule accompanying the application modified to such extent as the authority considers appropriate for the promotion of the licensing objectives, and

- (ii) any condition which must under section 19, 20 or 21 of the Licensing Act 2003 be included in the licence;

- (b) to exclude from the scope of the licence any of the licensable activities to which the application relates;
- (c) to refuse to specify a person in the licence as the premises supervisor;
- (d) to reject the variation

For the purposes of 3.1(a) (i) above, the conditions of the licence are modified if any of them are altered or omitted or any new conditions added.

4. POST DECISION IMPLEMENTATION

- 4.1 The decision will have immediate effect

5. IMPLICATIONS OF DECISION

5.1 Corporate Priorities and Performance

- 5.1.1 Members are referred to the Council's Licensing Policy for consideration

- 5.1.2 Timely legal and fair decisions support objectives contained within the Corporate Plan. In particular in relation to a "successful London borough" by ensuring that only legal, well regulated licensable activities occur within the borough.

5.2 Resources (Finance & Value for Money, Procurement, Staffing, IT, Property, Sustainability)

- 5.2.1 N/A

5.3 Legal and Constitutional References

- 5.3.1 The Licensing Act 2003 sets out how applications for variations to premises licences should be dealt with where valid representations have been submitted.

- 5.3.2 Under the Council's Constitution, Article 7, the licensing sub-committee has responsibility delegated to it (from the Licensing Committee) for licensing hearings concerning all licensing matters.

5.4 Risk Management

- 5.4.1 N/A

5.5 Equalities and Diversity

- 5.5.1 Licence applications are dealt with according to the provisions of the Licensing Act 2003 and associated Regulations which allow both applications and representations to applications to be made by all sectors.

5.6 **Consultation and Engagement**

5.6.1 The statutory consultation process has been followed in accordance with the Licensing Act 2003.

6. **BACKGROUND PAPERS**

6.1 The application and report of the Licensing Officer and appendices are attached to this report.

Officers Report

LICENSING ACT 2003

OFFICER REPORT

Flavours 218 burnt Oak Broadway Edgware HA8 0AP

1. The Applicants

The application before the subcommittee was submitted under Section 34 of the Licensing Act 2003. It is an application for a full Variation of a Premises licence , submitted by Ashish Modion the licence holder.

2. Application

The original licence was granted on 08th June 2013. The tables below show the following activities. and hours that the premises is currently licensed for.

The Exhibition of film's - Both indoors and outdoors

Day	Current licence permitted start time	Current licence Permitted finishes times
Monday	11:00hrs	00:30hrs (the following day)
Tuesday	11:00hrs	00:30hrs (the following day)
Wednesday	11:00hrs	00:30hrs (the following day)
Thursday	11:00hrs	00:30hrs (the following day)
Friday	11:00hrs	01:30hrs (the following day)
Saturday	11:00hrs	01:30hrs (the following day)
Sunday	11:00hrs	00:30hrs (the following day)

The Performance of live music - Indoors only

Day	Current licence permitted start time	Current licence Permitted finishes times
Monday	11:00hrs	00:00hrs (the following day)
Tuesday	11:00hrs	00:00hrs (the following day)
Wednesday	11:00hrs	00:00hrs (the following day)
Thursday	11:00hrs	00:00hrs (the following day)
Friday	11:00hrs	01:00hrs (the following day)
Saturday	11:00hrs	01:00hrs (the following day)
Sunday	11:00hrs	00:00hrs (the following day)

The Performance of dance - Both indoors and outdoors

Day	Current licence permitted start time	Current licence Permitted finishes times
Monday	11:00hrs	00:00hrs (the following day)
Tuesday	11:00hrs	00:00hrs (the following day)
Wednesday	11:00hrs	00:00hrs (the following day)
Thursday	11:00hrs	00:00hrs (the following day)
Friday	11:00hrs	01:00hrs (the following day)
Saturday	11:00hrs	01:00hrs (the following day)
Sunday	11:00hrs	00:00hrs (the following day)

The Playing of recorded music - Both indoors and outdoors

Day	Current licence permitted start time	Current licence Permitted finishes times
Monday	11:00hrs	00:30hrs (the following day)
Tuesday	11:00hrs	00:30hrs (the following day)
Wednesday	11:00hrs	00:30hrs (the following day)
Thursday	11:00hrs	00:30hrs (the following day)
Friday	11:00hrs	01:30hrs (the following day)
Saturday	11:00hrs	01:30hrs (the following day)
Sunday	11:00hrs	00:30hrs (the following day)

The Provision of late night refreshment - Both indoors and outdoors

Day	Current licence permitted start time	Current licence Permitted finishes times
Monday	23:00hrs	00:30hrs (the following day)
Tuesday	23:00hrs	00:30hrs (the following day)
Wednesday	23:00hrs	00:30hrs (the following day)
Thursday	23:00hrs	00:30hrs (the following day)
Friday	23:00hrs	01:30hrs (the following day)
Saturday	23:00hrs	01:30hrs (the following day)
Sunday	23:00hrs	00:30hrs (the following day)

Sale by retail of alcohol (on Sales)

Day	Current licence permitted start time	Current licence Permitted finishes times
Monday	11:00hrs	00:30hrs (the following day)
Tuesday	11:00hrs	00:30hrs (the following day)
Wednesday	11:00hrs	00:30hrs (the following day)
Thursday	11:00hrs	00:30hrs (the following day)
Friday	11:00hrs	01:30hrs (the following day)
Saturday	11:00hrs	01:30hrs (the following day)
Sunday	11:00hrs	00:30hrs (the following day)

Indoor sporting event

Day	Current licence permitted start time	Current licence Permitted finishes times
Monday	11:00hrs	00:30hrs (the following day)
Tuesday	11:00hrs	00:30hrs (the following day)
Wednesday	11:00hrs	00:30hrs (the following day)
Thursday	11:00hrs	00:30hrs (the following day)
Friday	11:00hrs	01:30hrs (the following day)
Saturday	11:00hrs	01:30hrs (the following day)
Sunday	11:00hrs	00:30hrs (the following day)

The hours that the premises are open to the public

Day	Current licence permitted start time	Current licence Permitted finishes times
Monday	11:00hrs	01:00hrs (the following day)
Tuesday	11:00hrs	01:00hrs (the following day)
Wednesday	11:00hrs	00:30hrs (the following day)
Thursday	11:00hrs	01:00hrs (the following day)
Friday	11:00hrs	02:00hrs (the following day)
Saturday	11:00hrs	02:00hrs (the following day)
Sunday	11:00hrs	01:00hrs (the following day)

The Applicant applied to vary the following activities (listed below) and the hours listed below on the table s listed below.

- **The Performance of live music**
- **The Playing of recorded music - Both indoors and outdoors**
- **The Performance of dance - Both indoors and outdoors**
- **The Provision of late night refreshment - Both indoors and outdoors**
- **Sale by retail of alcohol (on Sales)**

Day	Applied for permitted start time	Applied for Permitted finishes times
Monday	10:00hrs	04:00 (the following day)
Tuesday	10:00hrs	04:00 (the following day)
Wednesday	10:00hrs	04:00 (the following day)
Thursday	10:00hrs	04:00 (the following day)
Friday	10:00hrs	04:00 (the following day)
Saturday	10:00hrs	04:00 (the following day)
Sunday	10:00hrs	04:00 (the following day)

During the application process the applicant agreed with the police to amend the sale of alcohol hours to those shown on the tables below.

Please be advised if the Licensing-sub committed are minded granting this application, the hours regarding the sale of alcohol will be as the following.

Day	Amended hours applied for <u>On Sales</u>-permitted start time	Amended hours applied for <u>On Sales</u> -Permitted finishes times
Monday	10:00hrs	03:30hrs (the following day)
Tuesday	10:00hrs	03:30hrs (the following day)
Wednesday	10:00hrs	03:30hrs (the following day)
Thursday	10:00hrs	03:30hrs (the following day)
Friday	10:00hrs	03:30hrs (the following day)
Saturday	10:00hrs	03:30hrs (the following day)
Sunday	10:00hrs	03:30hrs (the following day)

Whilst requesting to vary the hours for sale or supply of alcohol, the applicant would like to add the following activities and times to the licence:- **Anything of a Similar Description to that falling within definition of Performance of live music, The Playing of recorded music and The Performance of dance.**

Day	Applied for permitted start time	Applied for Permitted finishes times
Monday	10:00hrs	04:00 (the following day)
Tuesday	10:00hrs	04:00 (the following day)
Wednesday	10:00hrs	04:00 (the following day)
Thursday	10:00hrs	04:00 (the following day)
Friday	10:00hrs	04:00 (the following day)
Saturday	10:00hrs	04:00 (the following day)
Sunday	10:00hrs	04:00 (the following day)

Hours the premises will be open to the public.

Day	Applied for permitted start time	Applied for Permitted finishes times
Monday	10:00hrs	05:00 (the following day)
Tuesday	10:00hrs	05:00 (the following day)
Wednesday	10:00hrs	05:00 (the following day)
Thursday	10:00hrs	05:00 (the following day)
Friday	10:00hrs	05:00 (the following day)
Saturday	10:00hrs	05:00 (the following day)
Sunday	10:00hrs	05:00 (the following day)

A copy of the original licence can be seen attached to this report in **Annex 1**. A full copy of the variation application form can be seen attached to this report in **Annex 2**.

During the consultation period, the applicant was in discussion with the Police regarding conditions to include on the amended licence. This communication can be found in **Annex 3**.

3. Representations

The Licensing Team received one valid representation from a ward councilor. The representation relates to the licensing objective surrounding the prevention of Noise and nuisance.

The representation and supporting information can be seen attached to this report in **Annex 4**.

4. Attaching conditions

The operating schedule, which is part of the application, includes certain additional steps that the applicant will take to protect the licensing objectives. These will become enforceable conditions, should the licence be granted. Additional conditions may be attached to the licence if the committee thinks it appropriate.

The Committee must have regard to all of the representations made and the evidence it hears and is asked to note that it may not attach conditions or reject the whole or part of the application merely because it considers it desirable to do so. It must actually be appropriate in order to promote the licensing objectives.

In relation to conditions, the statutory guidance at chapter 10.8 states that "The licensing authority may not impose any conditions unless its discretion has been engaged following receipt of relevant representations and it is satisfied as a result of a hearing (unless all parties agree a hearing is not necessary) that it is appropriate to impose conditions to promote one or more of the four licensing objectives.

Full Copies of the Councils Statement of Licensing Policy, the Statutory Guidance to the Act and the Council's Guide to Good Practice at Licensed Premises will be available at the Licensing Sub Committee hearing or in advance if required.

Elisabeth Hammond
Licensing Officer

Annex 1 – Original Licence
Annex 2 – Application Form and plan
Annex 3 – Conditions agreed with the Police
Annex 4 – Representations and supporting documentation
Annex 5 – Matters for Decision

Original Licence

<p>Licensing Act 2003</p> <p>Part A:</p> <p>Premises Licence</p> <p>Premises Licence Number: LN/200713560</p>	<p>Licensing Authority: London Borough of Barnet, Building 4, North London Business Park Oakleigh Road South New Southgate, London, N11 1NP</p> <p style="text-align: right;">LPRL/13/07373 (05/03/2014)</p>
---	---

Part 1 – Premises details

Postal address of premises, or if none, ordnance survey map reference or description Flavours, 218 Burnt Oak Broadway	
Post Town Edgware	Post code HA8 0AP
Telephone number 020 8951 2500	

Where the licence is time limited the dates This premises licence is not time limited

Licensable activities authorised by the licence The Sale by Retail of Alcohol The Provision of Regulated Entertainment The Provision of Late Night Refreshment
--

The times the licence authorises the carrying out of licensable activities	
<u>Sale by retail of alcohol</u>	
<u>Standard Days and Timings:</u>	
Sunday to Thursday	11:00hrs - 00:30hrs
Friday to Saturday	11:00hrs - 01:00hrs
<u>The Exhibition of film's - Both indoors and outdoors</u>	
<u>Standard Days and Timings:</u>	
Sunday to Thursday	11:00hrs - 00:30hrs
Friday to Saturday	11:00hrs - 01:30hrs
<u>Indoor sporting event</u>	
<u>Standard Days and Timings:</u>	
Sunday to Thursday	11:00hrs - 00:30hrs
Friday to Saturday	11:00hrs - 01:30hrs
<u>The Performance of live music - Indoors only</u>	
<u>Standard Days and Timings:</u>	
Sunday to Thursday	11:00hrs - 00:00hrs
Friday to Saturday	11:00hrs - 01:00hrs

The Playing of recorded music - Both indoors and outdoors

Standard Days and Timings:

Sunday to Thursday	11:00hrs - 00:00hrs
Friday to Saturday	11:00hrs - 01:30hrs

The Performance of dance - Both indoors and outdoors

Standard Days and Timings:

Sunday to Thursday	11:00hrs - 00:00hrs
Friday to Saturday	11:00hrs - 01:00hrs

The Provision of late night refreshment - Both indoors and outdoors

Standard Days and Timings:

Sunday to Thursday	23:00hrs - 00:30hrs
Friday to Saturday	23:00hrs - 01:30hrs

The hours that the premises are open to the public

Standard Days and Timings

Sunday to Thursday	11:00hrs - 00:30hrs
Friday to Saturday	11:00hrs - 01:30hrs

Where the licence authorises supplies of alcohol whether these are on and/ or off supplies

On supplies only

Part 2

Name, (registered) address, telephone number and email (where relevant) of holder of premises licence

Ashok Kumar Gordhandas Tulshidas Modi
Crownvale Entertainment Ltd t/a Flavours
144-146 Kings Cross Road
London
WC1X 9DU

Registered number of holder, for example company number, charity number (where applicable)

6816476

Name, address and telephone number of designated premises supervisor where the premises licence authorises for the supply of alcohol

Ashok Kumar Gordhandas Tulshidas Modi

Personal licence number and issuing authority of personal licence held by designated premises supervisor where the premises licence authorises for the supply of alcohol

01SK/WK/200507308 - London Borough of Barnet

Annex 1 - Mandatory Conditions

- 1 No supply of alcohol may be made under the premises licence-
 - (a) at a time when there is no designated premises supervisor in respect of the premises licence, or
 - (b) at a time when the designated premises supervisor does not hold a personal licence or his personal licence is suspended.
- 2 Every supply of alcohol under the premises licence must be made or authorised by a person who holds a personal licence.
 - i. (1)The responsible person shall take all reasonable steps to ensure that staff on relevant premises do not carry out, arrange or participate in any irresponsible promotions in relation to the premises.

(2)In this paragraph, an irresponsible promotion means any one or more of the following activities, or substantially similar activities, carried on for the purpose of encouraging the sale or supply of alcohol for consumption on the premises in a manner which carries a significant risk of leading or contributing to crime and disorder, prejudice to public safety, public nuisance, or harm to children-

 - (a) games or other activities which require or encourage, or are designed to require or encourage, individuals to-
 - (i) drink a quantity of alcohol within a time limit (other than to drink alcohol sold or supplied on the premises before the cessation of the period in which the responsible person is authorised to sell or supply alcohol), or
 - (ii) drink as much alcohol as possible (whether within a time limit or otherwise);
 - (b) provision of unlimited or unspecified quantities of alcohol free or for a fixed or discounted fee to the public or to a group defined by a particular characteristic (other than any promotion or discount available to an individual in respect of alcohol for consumption at a table meal, as defined in section 159 of the Act);
 - (c) provision of free or discounted alcohol or any other thing as a prize to encourage or reward the purchase and consumption of alcohol over a period of 24 hours or less;
 - (d) provision of free or discounted alcohol in relation to the viewing on the premises of a sporting event, where that provision is dependent on-
 - (i) the outcome of a race, competition or other event or process, or
 - (ii) the likelihood of anything occurring or not occurring;
 - (e) selling or supplying alcohol in association with promotional posters or flyers on, or in the vicinity of, the premises which can reasonably be considered to condone, encourage or glamorise anti-social behaviour or to refer to the effects of drunkenness in any favourable manner.
 - ii. The responsible person shall ensure that no alcohol is dispensed directly by one person into the mouth of another (other than where that other person is unable to drink without assistance by reason of a disability).
 - iii. The responsible person shall ensure that free tap water is provided on request to customers where it is reasonably available.

- 3
- iv. (1) The premises licence holder or club premises certificate holder shall ensure that an age verification policy applies to the premises in relation to the sale or supply of alcohol.
- (2) The policy must require individuals who appear to the responsible person to be under 18 years of age (or such older age as may be specified in the policy) to produce on request, before being served alcohol, identification bearing their photograph, date of birth and a holographic mark.
- v. The responsible person shall ensure that—
- (a) where any of the following alcoholic drinks is sold or supplied for consumption on the premises (other than alcoholic drinks sold or supplied having been made up in advance ready for sale or supply in a securely closed container) it is available to customers in the following measures—
- (i) beer or cider: ½ pint;
- (ii) gin, rum, vodka or whisky: 25 ml or 35 ml; and
- (iii) still wine in a glass: 125 ml; and
- (b) customers are made aware of the availability of these measures.

Annex 2 – Conditions consistent with the operating schedule

- 4 CCTV will be installed and comply to the following specifications:
- a. Digital recording colour CCTV comprising a multi camera system.
- b. The head unit (recorder) for storing images will store such data on a hard drive or a similar quality medium.
- c. A CD or DVD burner will also form part of the system to facilitate making copies of the images.
- d. If the head unit is kept on the premises it must be located in a secure cabinet or other secure area, preferably out of the sight and reach of the public. The unit must be further secured by physical means to prevent anyone from merely picking up and removing the unit, e.g. a secure metal boot or metal case strap bolted to an immovable object like wall or floor.
- e. The quality of the images be of a sufficiently high standards to allow identification of a subject matter.
- f. Cameras will cover key areas identified by the operator and Police. These will include external cameras covering the outside area used by patrons of the premises, the external entrance and exit doors, clear head shots of persons entering the premises, approach route to the toilets, the bar and till areas and other areas not in full view from the bar.
- g. Images must be retained for a period of 31 days before overwriting.
- h. The images will be made available in reasonable time on demand by the Police or authorised officers of the Local authority.
- i. At all times when the premises are open there shall be at least one person who is capable of operating the CCTV system if required to do so by the Police or authorised officers of local authority.
- j. This system will be fully maintained at all times to ensure correct operation.
- 5 The licence holder will comply with all fire and health and safety legislation.
- 6 The licensable activities of regulated entertainment and late night refreshment shall cease in the outdoor areas at 23:30.

- 7 Live music shall only be staged within the enclosed bar area.
- 8 All windows of the premises shall be closed by 23:00.
- 9 Signage shall be prominently displayed at exits of the premises asking patrons to leave quietly.
- 10 No alcohol shall be sold to persons underage and when in doubt a request for an acceptable form of photo I.D will be made.

Annex 3 – Conditions attached after hearing by the licensing authority

N/A

Annex 4 - Plan

As submitted to the Council with the application for the grant of a premises licence under schedule 8 of the Licensing Act 2003. Reference: LPRL/13/07373

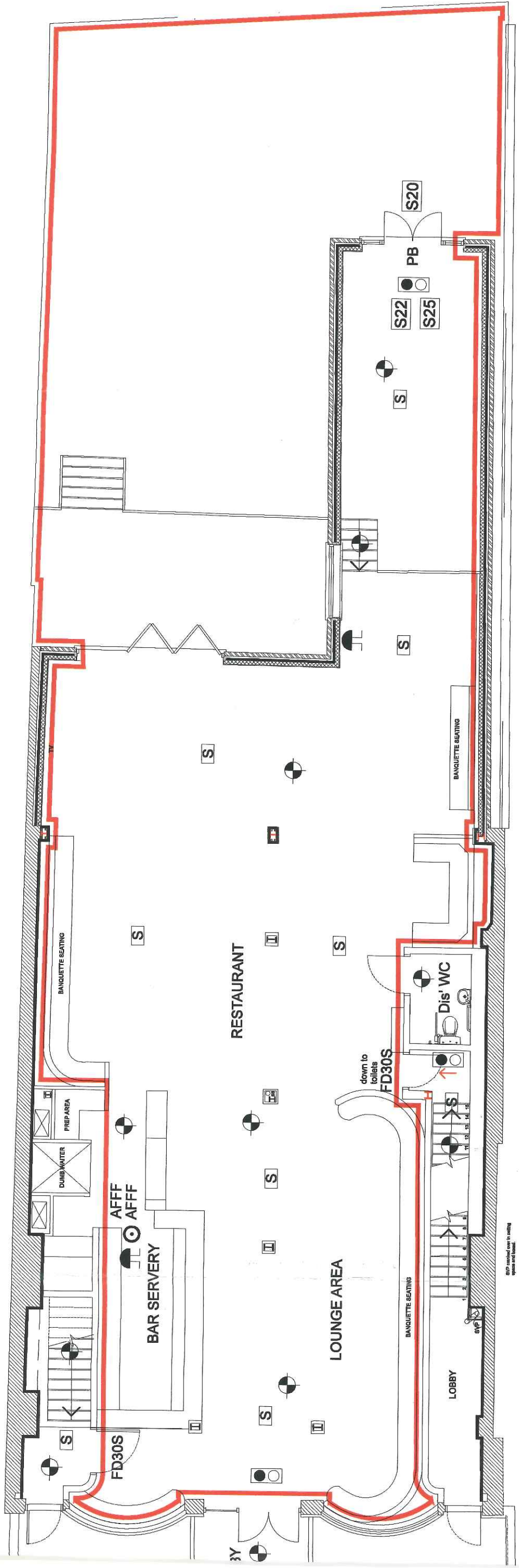

Ground Floor Plan as Proposed

11 Check / Upgrade existing ceilings between a) basement cellar and

Licensing Act 2003

Part B: Premises Licence Summary

Premises Licence Number:
LN/200713560

Licensing Authority:
London Borough of Barnet,
Building 4, North London Business Park
Oakleigh Road South
New Southgate,
London,
N11 1NP

LPRL/13/07373 05/03/2014

Premises details

Postal address of premises, or if none, ordnance survey map reference or description

Flavours, 218 Burnt Oak Broadway

Post Town

Edgware

Post code

HA8 0AP

Telephone number

020 8951 2500

Where the licence is time limited the dates

This premises licence is not time limited

Licensable activities authorised by the licence

The Sale by Retail of Alcohol
The Provision of Regulated Entertainment
The Provision of Late Night Refreshment

The times the licence authorises the carrying out of licensable activities

Sale by retail of alcohol

Standard Days and Timings:

Sunday to Thursday	11:00hrs - 00:30hrs
Friday to Saturday	11:00hrs - 01:00hrs

The Exhibition of film's - Both indoors and outdoors

Standard Days and Timings:

Sunday to Thursday	11:00hrs - 00:30hrs
Friday to Saturday	11:00hrs - 01:30hrs

Indoor sporting event

Standard Days and Timings:

Sunday to Thursday	11:00hrs - 00:30hrs
Friday to Saturday	11:00hrs - 01:30hrs

The Performance of live music - Indoors only

Standard Days and Timings:

Sunday to Thursday	11:00hrs - 00:00hrs
Friday to Saturday	11:00hrs - 01:00hrs

The Playing of recorded music - Both indoors and outdoors

Standard Days and Timings:

Sunday to Thursday	11:00hrs - 00:00hrs
Friday to Saturday	11:00hrs - 01:30hrs

The Performance of dance - Both indoors and outdoors

Standard Days and Timings:

Sunday to Thursday	11:00hrs - 00:00hrs
Friday to Saturday	11:00hrs - 01:00hrs

The Provision of late night refreshment - Both indoors and outdoors

Standard Days and Timings:

Sunday to Thursday	23:00hrs - 00:30hrs
Friday to Saturday	23:00hrs - 01:30hrs

The hours that the premises are open to the public

Standard Days and Timings

Sunday to Thursday	11:00hrs - 00:30hrs
Friday to Saturday	11:00hrs - 01:30hrs

Where the licence authorises supplies of alcohol whether these are on and/ or off supplies

On supplies only

Name, (registered) address of holder of premises licence

Ashok Kumar Gordhandas Tulshidas Modi
Crownvale Entertainment Ltd t/a Flavours
144-146 Kings Cross Road
London
WC1X 9DU

Registered number of holder, for example company number, charity number (where applicable)

6816476

Name of designated premises supervisor where the premises licence authorises for the supply of alcohol

Ashok Kumar Gordhandas Tulshidas Modi

State whether access to the premises by children is restricted or prohibited

No additional restrictions or prohibitions other than those imposed by the Licensing Act 2003

Application form

Application to vary a premises licence under the Licensing Act 2003

PLEASE READ THE FOLLOWING INSTRUCTIONS FIRST

Before completing this form please read the guidance notes at the end of the form. If you are completing this form by hand please write legibly in block capitals. In all cases ensure that your answers are inside the boxes and written in black ink. Use additional sheets if necessary.

You may wish to keep a copy of the completed form for your records.

I/We **Ashok kumar Gordhandas Tulsidas Modi**

(Insert name(s) of applicant)

being the premises licence holder, apply to vary a premises licence under section 34 of the Licensing Act 2003 for the premises described in Part 1 below

Premises licence number
LN/200713560

Part 1 – Premises Details

Postal address of premises or, if none, ordnance survey map reference or description
218 Burnt Oak Broadway, Burnt Oak,

Post town	Edgware	Postcode	HA8 0AP
-----------	---------	----------	---------

Telephone number at premises (if any)	020 8951 2500
---------------------------------------	---------------

Non-domestic rateable value of premises	£ 68,500
---	----------

Part 2 – Applicant details

Daytime contact telephone number	07595388736		
E-mail address (optional)			
Current postal address if different from premises address			
Post town		Postcode	

Part 3 - Variation

Please tick as appropriate

Do you want the proposed variation to have effect as soon as possible? Yes No

If not, from what date do you want the variation to take effect? DD MM YYYY

--	--	--	--	--	--	--	--	--	--

Do you want the proposed variation to have effect in relation to the introduction of the late night levy? (Please see guidance note 1) Yes No

Please describe briefly the nature of the proposed variation (Please see guidance note 2)
To increase the hours for the sale of alcohol and to amend the seasonal variations.
To add the following licensable activities: - Live Music - Recorded Music - Dancing - Anything of a similar description - Late night refreshment-Late night sale of alcohol

If your proposed variation would mean that 5,000 or more people are expected to attend the premises at any one time, please state the number expected to attend:

Part 4 Operating Schedule

Please complete those parts of the Operating Schedule below which would be subject to change if this application to vary is successful.

Provision of regulated entertainment (Please see guidance note 3) Please tick all that apply

- a) plays (if ticking yes, fill in box A)
- b) films (if ticking yes, fill in box B)
- c) indoor sporting events (if ticking yes, fill in box C)
- d) boxing or wrestling entertainment (if ticking yes, fill in box D)
- e) live music (if ticking yes, fill in box E)
- f) recorded music (if ticking yes, fill in box F)
- g) performances of dance (if ticking yes, fill in box G)
- h) anything of a similar description to that falling within (e), (f) or (g) (if ticking yes, fill in box H)

Provision of late night refreshment (if ticking yes, fill in box I)

Supply of alcohol (if ticking yes, fill in box J)

In all cases complete boxes K, L and M

A

Plays Standard days and timings (please read guidance note 8)			<u>Will the performance of a play take place indoors or outdoors or both – please tick (please read guidance note 4)</u>	Indoors	<input type="checkbox"/>
				Outdoors	<input type="checkbox"/>
				Both	<input type="checkbox"/>
Day	Start	Finish			
Mon			<u>Please give further details here (please read guidance note 5)</u>		
Tue			<u>Please give further details here (please read guidance note 5)</u>		
Wed			<u>State any seasonal variations for performing plays (please read guidance note 6)</u>		
Thur			<u>State any seasonal variations for performing plays (please read guidance note 6)</u>		
Fri			<u>Non standard timings. Where you intend to use the premises for the performance of plays at different times to those listed in the column on the left, please list (please read guidance note 7)</u>		
Sat					
Sun			<u>Non standard timings. Where you intend to use the premises for the performance of plays at different times to those listed in the column on the left, please list (please read guidance note 7)</u>		

B

Films Standard days and timings (please read guidance note 8)			<u>Will the exhibition of films take place indoors or outdoors or both – please tick (please read guidance note 4)</u>	Indoors	<input type="checkbox"/>
				Outdoors	<input type="checkbox"/>
				Both	<input type="checkbox"/>
Day	Start	Finish	<u>Please give further details here (please read guidance note 5)</u>		
Mon					
			<u>State any seasonal variations for the exhibition of films (please read guidance note 6)</u>		
Tue					
			<u>Non standard timings. Where you intend to use the premises for the exhibition of films at different times to those listed in the column on the left, please list (please read guidance note 7)</u>		
Wed					
Thur					
Fri					
Sat					
Sun					

C

Indoor sporting events Standard days and timings (please read guidance note 8)			Please give further details (please read guidance note 5)
Day	Start	Finish	
Mon			
Tue			State any seasonal variations for indoor sporting events (please read guidance note 6)
Wed			
Thur			Non standard timings. Where you intend to use the premises for indoor sporting events at different times to those listed in the column on the left, please list (please read guidance note 7)
Fri			
Sat			
Sun			

D

Boxing or wrestling entertainments Standard days and timings (please read guidance note 8)			<u>Will the boxing or wrestling entertainment take place indoors or outdoors or both – please tick</u> (please read guidance note 4)	Indoors	<input type="checkbox"/>
				Outdoors	<input type="checkbox"/>
				Both	<input type="checkbox"/>
Day	Start	Finish	<u>Please give further details here</u> (please read guidance note 5)		
Mon					
			<u>State any seasonal variations for boxing or wrestling entertainment</u> (please read guidance note 6)		
Tue					
			<u>Non standard timings. Where you intend to use the premises for boxing or wrestling entertainment at different times to those listed in the column on the left, please list</u> (please read guidance note 7)		
Wed					
Thur					
Fri					
Sat					
Sun					

E

Live music Standard days and timings (please read guidance note 8)			Will the performance of live music take place <u>indoors or outdoors or both</u> – please tick (please read guidance note 4)	Indoors	<input checked="" type="checkbox"/>
				Outdoors	<input type="checkbox"/>
				Both	<input type="checkbox"/>
Day	Start	Finish	Please give further details here (please read guidance note 5)		
Mon	10:00	00:00			
	00:00	04:00			
Tue	10:00	00:00			
	00:00	04:00			
Wed	10:00	00:00			
	00:00	04:00			
Thur	10:00	00:00			
	00:00	04:00			
Fri	10:00	00:00			
	00:00	04:00			
Sat	10:00	00:00			
	00:00	04:00			
Sun	10:00	00:00			
	00:00	04:00			

F

Recorded music Standard days and timings (please read guidance note 8)			Will the playing of recorded music take place indoors or outdoors or both – please tick (please read guidance note 4)	Indoors	<input checked="" type="checkbox"/>			
				Outdoors	<input type="checkbox"/>			
				Both	<input type="checkbox"/>			
Day	Start	Finish	<u>Please give further details here</u> (please read guidance note 5)					
Mon	10:00	00:00						
		00:00				04:00		
Tue	10:00	00:00						
		00:00				04:00		
Wed	10:00	00:00				<u>State any seasonal variations for the playing of recorded music</u> (please read guidance note 6)		
		00:00						
Thur	10:00	00:00						
		00:00						
Fri	10:00	00:00						
		00:00	04:00					
Sat	10:00	00:00						
		00:00	04:00					
Sun	10:00	00:00						
		00:00	04:00					

G

Performances of dance Standard days and timings (please read guidance note 8)			Will the performance of dance take place indoors or outdoors or both – please tick (please read guidance note 4)	Indoors	<input checked="" type="checkbox"/>
				Outdoors	<input type="checkbox"/>
				Both	<input type="checkbox"/>
Day	Start	Finish			
Mon	10:00	00:00	Please give further details here (please read guidance note 5)		
	00:00	04:00			
Tue	10:00	00:00			
	00:00	04:00			
Wed	10:00	00:00	State any seasonal variations for the performance of dance (please read guidance note 6)		
	00:00	04:00			
Thur	10:00	00:00			
	00:00	04:00			
Fri	10:00	00:00	Non standard timings. Where you intend to use the premises for the performance of dance at different times to those listed in the column on the left, please list (please read guidance note 7)		
	00:00	04:00			
Sat	10:00	00:00			
	00:00	04:00			
Sun	10:00	00:00			
	00:00	04:00			

H

Anything of a similar description to that falling within (e), (f) or (g) Standard days and timings (please read guidance note 8)			Please give a description of the type of entertainment you will be providing		
Day	Start	Finish	<u>Will this entertainment take place indoors or outdoors or both – please tick</u> (please read guidance note 4)	Indoors	<input checked="" type="checkbox"/>
Mon	10:00	00:00		Outdoors	<input type="checkbox"/>
	00:00	04:00		Both	<input type="checkbox"/>
Tue	10:00	00:00	<u>Please give further details here</u> (please read guidance note 5)		
	00:00	04:00			
Wed	10:00	00:00			
	00:00	04:00			
Thur	10:00	00:00	<u>State any seasonal variations for entertainment of a similar description to that falling within (e), (f) or (g)</u> (please read guidance note 6)		
	00:00	04:00			
Fri	10:00	00:00			
	00:00	04:00			
Sat	10:00	00:00	<u>Non standard timings. Where you intend to use the premises for the entertainment of a similar description to that falling within (e), (f) or (g) at different times to those listed in the column on the left, please list</u> (please read guidance note 7)		
	00:00	04:00			
Sun	10:00	00:00			
	00:00	04:00			

I

Late night refreshment Standard days and timings (please read guidance note 8)			Will the provision of late night refreshment take place indoors or outdoors or both – please tick (please read guidance note 4)	Indoors	<input checked="" type="checkbox"/>			
				Outdoors	<input type="checkbox"/>			
				Both	<input type="checkbox"/>			
Day	Start	Finish						
Mon	10:00	00:00	<u>Please give further details here</u> (please read guidance note 5)					
	00:00	04:00						
Tue	10:00	00:00						
	00:00	04:00						
Wed	10:00	00:00				<u>State any seasonal variations for the provision of late night refreshment</u> (please read guidance note 6)		
	00:00	04:00						
Thur	10:00	00:00						
	00:00	04:00						
Fri	10:00	00:00	<u>Non standard timings. Where you intend to use the premises for the provision of late night refreshment at different times, to those listed in the column on the left, please list</u> (please read guidance note 7)					
	00:00	04:00						
Sat	10:00	00:00						
	00:00	04:00						
Sun	10:00	00:00						
	00:00	04:00						

J

Supply of alcohol Standard days and timings (please read guidance note 8)			Will the supply of alcohol be for consumption – please tick (please read guidance note 9)	On the premises	<input checked="" type="checkbox"/>	
Day	Start	Finish		Off the premises	<input type="checkbox"/>	
Mon	10:00	00:00	State any seasonal variations for the supply of alcohol (please read guidance note 6)	Both	<input type="checkbox"/>	
	00:00	04:00				
Tue	10:00	00:00				
	00:00	04:00				
Wed	10:00	00:00				
	00:00	04:00				
Thur	10:00	00:00		Non-standard timings. Where you intend to use the premises for the supply of alcohol at different times to those listed in the column on the left, please list (please read guidance note 7)		
	00:00	04:00				
Fri	10:00	00:00				
	00:00	04:00				
Sat	10:00	00:00				
	00:00	04:00				
Sun	10:00	00:00				
	00:00	04:00				

K

<p>Please highlight any adult entertainment or services, activities, other entertainment or matters ancillary to the use of the premises that may give rise to concern in respect of children (please read guidance note 10).</p>
--

L

Hours premises are open to the public Standard days and timings (please read guidance note 8)			State any seasonal variations (please read guidance note 6)
Day	Start	Finish	
Mon	10:00	00:00	<p><u>Non standard timings. Where you intend the premises to be open to the public at different times from those listed in the column on the left, please list (please read guidance note 7)</u></p>
	00:00	05:00	
Tue	10:00	00:00	
	00:00	05:00	
Wed	10:00	00:00	
	00:00	05:00	
Thur	10:00	00:00	
	00:00	05:00	
Fri	10:00	00:00	
	00:00	05:00	
Sat	10:00	00:00	
	00:00	05:00	
Sun	10:00	00:00	
	00:00	05:00	

Please identify those conditions currently imposed on the licence which you believe could be removed as a consequence of the proposed variation you are seeking.
N/A

M Describe any additional steps you intend to take to promote the four licensing objectives as a result of the proposed variation:

a) General – all four licensing objectives (b, c, d and e) (please read guidance note 11)

Alcohol shall not be sold to non-residents of the premises other than between 10.00 and 04.00. All staff who are involved in the sale of alcohol will be trained in relation to the licensing objectives so as to reduce crime and disorder, promote public safety, prevent public nuisance and promote the protection of children from harm. Said training will be documented and will be made available to an authorised officer upon request.

b) The prevention of crime and disorder

c) Public safety

d) The prevention of public nuisance

Notices will be displayed at public exits, in a clear and prominent position, requesting that patrons respect the needs of any local residents and leave the premises and the area quietly. Whenever regulated entertainment is taking place, regular assessments shall be made of any noise emanating from the premises. Wherever said assessments indicate that noise is likely to cause nuisance to any local residents, remedial steps shall be taken to reduce the levels of noise.

e) The protection of children from harm

A "Challenge 25" policy shall be adopted and enforced at the premises whereby any person who appears to be under the age of 25 shall be required to provide identification to prove that they are over the age of 18. The following forms of identification are acceptable as proof: Passport; A UK Photocard Driving Licence; Official ID card issued by HM Forces or EU bearing a photograph and the date of birth of the holder; Any other form of identification agreed with the Police Licensing Unit. All staff who are involved in the sale of alcohol will be trained in relation to the Challenge 25 policy upon commencement of their employment, following which they will undertake refresher training at suitable intervals

Please tick as appropriate

- I have enclosed the premises licence
- I have enclosed the relevant part of the premises licence

If you have not ticked one of these boxes, please fill in reasons for not including the licence or part of it below

Reasons why I have not enclosed the premises licence or relevant part of premises licence.

Checklist:

Please tick to indicate agreement

- I have made or enclosed payment of the fee; or
- I have not made or enclosed payment of the fee because this application has been made in relation to the introduction of the late night levy.

- I have sent copies of this application and the plan to responsible authorities and others where applicable.
- I understand that I must now advertise my application.

- I have enclosed the premises licence or relevant part of it or explanation.

- I understand that if I do not comply with the above requirements my application will be rejected.

IT IS AN OFFENCE, UNDER SECTION 158 OF THE LICENSING ACT 2003, TO MAKE A FALSE STATEMENT IN OR IN CONNECTION WITH THIS APPLICATION. THOSE WHO MAKE A FALSE STATEMENT MAY BE LIABLE ON SUMMARY CONVICTION TO A FINE OF ANY AMOUNT.

Part 5 – Signatures (please read guidance note 12)

Signature of applicant (the current premises licence holder) or applicant’s solicitor or other duly authorised agent (please read guidance note 13). **If signing on behalf of the applicant, please state in what capacity.**

Signature	
Date	09/10/2022
Capacity	current lease owner. (Director)

Where the premises licence is jointly held, signature of 2nd applicant (the current premises licence holder) or 2nd applicant’s solicitor or other authorised agent (please read guidance note 14). **If signing on behalf of the applicant, please state in what capacity.**

Signature	
Date	
Capacity	

Contact name (where not previously given) and address for correspondence associated with this application (please read guidance note 15)			
Post town		Post code	
Telephone number (if any)			
If you would prefer us to correspond with you by e-mail, your e-mail address (optional)			

Notes for Guidance

This application cannot be used to vary the licence so as to extend the period for which the licence has effect or to vary substantially the premises to which it relates. If you wish to make that type of change to the premises licence, you should make a new premises licence application under section 17 of the Licensing Act 2003.

1. You do not have to pay a fee if the only purpose of the variation for which you are applying is to avoid becoming liable for the late night levy
2. Describe the premises. For example, the type of premises, its general situation and layout and any other information which could be relevant to the licensing objectives. Where your application includes off-supplies of alcohol and you intend to provide a place of consumption of these off-supplies of alcohol, you must include a description of where the place will be and its proximity to the premises.
3. In terms of specific regulated entertainments please note that:
 - Plays: no licence is required for performances between 08.00 and 23.00 on any day, provided that the audience does not exceed 500.
 - Films: no licence is required for 'not-for-profit' film exhibition held in community premises between 08.00 and 23.00 on any day provided that the audience does not exceed 500 and the organiser (a) gets consent to the screening from a person who is responsible for the premises; and (b) ensures that each such screening abides by age classification ratings.
 - Indoor sporting events: no licence is required for performances between 08.00 and 23.00 on any day, provided that the audience does not exceed 1000.
 - Boxing or Wrestling Entertainment: no licence is required for a contest, exhibition or display of Greco-Roman wrestling, or freestyle wrestling between 08.00 and 23.00 on any day, provided that the audience does not exceed 1000. Combined fighting sports – defined as a contest, exhibition or display which combines boxing or wrestling with one or more martial arts – are licensable as a boxing or wrestling entertainment rather than an indoor sporting event.
 - Live music: no licence permission is required for:
 - a performance of unamplified live music between 08.00 and 23.00 on any day, on any premises.
 - a performance of amplified live music between 08.00 and 23.00 on any day on premises authorised to sell alcohol for consumption on those premises, provided that the audience does not exceed 500.
 - a performance of amplified live music between 08.00 and 23.00 on any day, in a workplace that is not licensed to sell alcohol on those premises, provided that the audience does not exceed 500.

- a performance of amplified live music between 08.00 and 23.00 on any day, in a church hall, village hall, community hall, or other similar community premises, that is not licensed by a premises licence to sell alcohol, provided that (a) the audience does not exceed 500, and (b) the organiser gets consent for the performance from a person who is responsible for the premises.
 - a performance of amplified live music between 08.00 and 23.00 on any day, at the non-residential premises of (i) a local authority, or (ii) a school, or (iii) a hospital, provided that (a) the audience does not exceed 500, and (b) the organiser gets consent for the performance on the relevant premises from: (i) the local authority concerned, or (ii) the school or (iii) the health care provider for the hospital.
 - Recorded Music: no licence permission is required for:
 - any playing of recorded music between 08.00 and 23.00 on any day on premises authorised to sell alcohol for consumption on those premises, provided that the audience does not exceed 500.
 - any playing of recorded music between 08.00 and 23.00 on any day, in a church hall, village hall, community hall, or other similar community premises, that is not licensed by a premises licence to sell alcohol, provided that (a) the audience does not exceed 500, and (b) the organiser gets consent for the performance from a person who is responsible for the premises.
 - any playing of recorded music between 08.00 and 23.00 on any day, at the non-residential premises of (i) a local authority, or (ii) a school, or (iii) a hospital, provided that (a) the audience does not exceed 500, and (b) the organiser gets consent for the performance on the relevant premises from: (i) the local authority concerned, or (ii) the school proprietor or (iii) the health care provider for the hospital.
 - Dance: no licence is required for performances between 08.00 and 23.00 on any day, provided that the audience does not exceed 500. However, a performance which amounts to adult entertainment remains licensable.
 - Cross activity exemptions: no licence is required between 08.00 and 23.00 on any day, with no limit on audience size for:
 - any entertainment taking place on the premises of the local authority where the entertainment is provided by or on behalf of the local authority;
 - any entertainment taking place on the hospital premises of the health care provider where the entertainment is provided by or on behalf of the health care provider;
 - any entertainment taking place on the premises of the school where the entertainment is provided by or on behalf of the school proprietor; and
 - any entertainment (excluding films and a boxing or wrestling entertainment) taking place at a travelling circus, provided that (a) it takes place within a moveable structure that accommodates the audience, and (b) that the travelling circus has not been located on the same site for more than 28 consecutive days.
4. Where taking place in a building or other structure please tick as appropriate (indoors may include a tent).
 5. For example state type of activity to be authorised, if not already stated, and give relevant further details, for example (but not exclusively) whether or not music will be amplified or unamplified.
 6. For example (but not exclusively), where the activity will occur on additional days during the summer months.
 7. For example (but not exclusively), where you wish the activity to go on longer on a particular day e.g. Christmas Eve.

8. Please give timings in 24 hour clock (e.g. 16.00) and only give details for the days of the week when you intend the premises to be used for the activity.
9. If you wish people to be able to consume alcohol on the premises, please tick 'on the premises'. If you wish people to be able to purchase alcohol to consume away from the premises, please tick 'off the premises'. If you wish people to be able to do both, please tick 'both'.
10. Please give information about anything intended to occur at the premises or ancillary to the use of the premises which may give rise to concern in respect of children regardless of whether you intend children to have access to the premises, for example (but not exclusively) nudity or semi-nudity, films for restricted age groups or the presence of gaming machines.
11. Please list here steps you will take to promote all four licensing objectives together.
12. The application form must be signed.
13. An applicant's agent (for example solicitor) may sign the form on their behalf provided that they have actual authority to do so.
14. Where there is more than one applicant, each of the applicants or their respective agents must sign the application form.
15. This is the address which we shall use to correspond with you about this application.

Conditions agreed with the Police

Dear Nick,

Many thanks for the email and I agree to all the conditions .

Regards,

Ashok

On Thu, Dec 8, 2022 at 10:34 AM <Nicolai.P.Fanovich@met.police.uk> wrote:

Hi Ashok,

As discussed, please see the below proposed conditions. If you would like to make any changes, let me know.

1. CCTV shall be installed to Home Office Guidance standards and maintained in a good working condition and recordings shall be kept for 31 days and shall be made available to police and authorised Officers from the Council upon request. This must comply with the Data Protection Act including signage.
2. CCTV cameras shall be installed to cover all entry and exit points enabling clear facial recognition images and a clear head and shoulder image of every person entering or leaving in any light condition.
3. The CCTV system shall display on any recordings the correct date and time of the recording.
4. The CCTV system shall continually record and cover areas where alcohol is kept for selection and purchase by the public, whilst the premises is open for licensable activities. It shall operate during all times when customers remain on the premises.
5. A member of staff trained in the use of the CCTV system shall be available at the premises at all times that the premises are open to the public.
6. The Licence holder/DPS/Manager shall inspect and test that the CCTV is operational and working correctly on a weekly basis. A signed and dated

record of the CCTV examination and any findings shall be kept on the premises and made available to the police and authorised officers of the Local Authority on request.

7. The Premises Licence holder shall make sure that all staff are trained in the main principles of the Licensing Act 2003, notably the promotion of the four licensing objectives, and the specific conditions of this premises licence before being allowed to sell alcohol.

8. All staff will receive refresher training every six months about their responsibilities under the Licensing Act 2003 and training records will be available to police and authorised officers on reasonable request.

9. An incident log shall be kept at the premises, and made available for inspection on request to an authorised officer of the Council or the Police, which will record the following:

- (a) all crimes reported to the venue
- (b) all ejections of patrons
- (c) any complaints received
- (d) any incidents of disorder
- (e) any faults in the CCTV system or searching equipment or scanning equipment
- (f) any refusal of the sale of alcohol
- (g) any visit by a relevant authority or emergency service.

10. Alcohol is to be served in polycarbonate, plastic or shatter-proof glasses. No bottles shall be given to customers.

11. No person shall be allowed to leave or enter the premises whilst in the possession of any open drinking vessel, whether empty or containing any beverage.

12. A "Challenge 25" proof of age scheme shall be operated at the premises where the only acceptable forms of identification are the following recognised photographic identification cards: a driving licence, a passport, a military identification card or a Proof of Age card carrying a 'PASS' logo.

13. Notices advertising that the premises operates a "Challenge 25" scheme shall be displayed in a clear and prominent position at the premises entrance. All occasions when persons have been refused service shall be recorded in the premises register.

14. The premise licence holder or Designated Premises Supervisor shall ensure that all management and staff who are not personal licence holders are fully trained and briefed on the four licensing objectives and Challenge 25 and they are adhered to.

15. All deliveries shall take place during the normal working day (i.e. 09:00 to 18:00 daily).

16. Signage requesting customers to be respectful of others when entering or leaving the premises shall be installed in a prominent position by the premises' exit.

17. No more than 5 patrons shall be allowed to gather/smoke outside the premises at the same time and this shall be monitored regularly to ensure the potential for noise nuisance is controlled.

18. The level of music, noise and vibration emanating from the premises shall be arranged so as not to cause a nuisance to local residents and shall not be audible within any noise sensitive premises after 2300 hours.

19. There shall be a minimum of three door supervisors on any day when the premises are open for the sale of alcohol past 0100 hours, two shall be to control entrance to the premises and one to control order within the premises.

20. Door supervisors shall wear clothing that can be clearly and easily identified on CCTV.

21. A register/log containing the names, badge number, dates & times of duty security staff and any incidents that occur shall be kept and made available to the Police and Licensing Authority.

22. The total number of people on the premises including staff and performers shall not exceed 90.

Also, the supply of alcohol will be Mon-Sun 10:00 – 03:30.

Regards,

Nick

Nicolai Fanovich PC 2392NW | NW Licensing Officer - Barnet

Email: nicolai.p.fanovich@met.pnn.police.uk

Address: South Harrow Police Station, 74 Northolt Road, Harrow, HA2 0DN



Information is shared in the interests of the reduction and prevention of crime and disorder and to enhance community safety under Section 115 of the Crime and Disorder Act 1998.

Any sharing of information is prohibited unless specifically authorised by the author.

GSC Marking: **OFFICIAL** and may be subject to handling instructions and/or an additional caveat

NOTICE - This email and any attachments are solely for the intended recipient and may be confidential. If you have received this email in error, please notify the sender and delete it from your system. Do not use, copy or disclose the information contained in this email or in any attachment without the permission of the sender. Metropolitan Police Service (MPS) communication systems are monitored to the extent permitted by law and any email and/or attachments may be read by monitoring staff. Only specified personnel are authorised to conclude binding agreements on behalf of the MPS by email and no responsibility is accepted for unauthorised agreements reached with other personnel. While reasonable precautions have been taken to ensure no viruses are present in this email, its security and that of any attachments cannot be guaranteed.

Representations

Cllr Sara Conway' representation

From: Conway, Cllr Sara <Cllr.S.Conway@Barnet.gov.uk>

Sent: 06 December 2022 17:48

To: Cudjoe, Zekiel <Zekiel.Cudjoe@Barnet.gov.uk>; Hammond, Elisabeth <Elisabeth.Hammond@Barnet.gov.uk>

Cc: Gurung, Cllr Kamal <Cllr.K.Gurung@Barnet.gov.uk>; Naqvi, Cllr Ammar <Cllr.A.Naqvi@Barnet.gov.uk>

Subject: Re: Variation to a premise Licence - Flavours 218 Burnt Oak Broadway Edgware HA8 0AP LAPRE4/22/67285

Thank you Zekiel, sorry I've not done this for a venue premises before.

In terms of public disorder and ASB this application is in a cumulative licensing zone and ASB hotspot, including in relation to alcohol, we are particularly concerned about the sale of alcohol from 10pm-4am.

Best wishes

Sara

Get [Outlook for Android](#)

From: Cudjoe, Zekiel <Zekiel.Cudjoe@Barnet.gov.uk>

Sent: Tuesday, December 6, 2022 1:43:10 PM

To: Conway, Cllr Sara <Cllr.S.Conway@Barnet.gov.uk>; Hammond, Elisabeth <Elisabeth.Hammond@Barnet.gov.uk>

Cc: Gurung, Cllr Kamal <Cllr.K.Gurung@Barnet.gov.uk>; Naqvi, Cllr Ammar <Cllr.A.Naqvi@Barnet.gov.uk>

Subject: RE: Variation to a premise Licence - Flavours 218 Burnt Oak Broadway Edgware HA8 0AP LAPRE4/22/67285

Good Morning Cllr Conway

Thank you for your Comment, on the below application , however I will be unable to accept your comment as a valid representation.

To submit a valid representation, and in term generate the need to present this application at a licensing sub-committee, your representation must detail how you believe that this application will have a negative effect on the licensing objective.

- The prevention of crime and disorder,
- Public safety,
- The prevention of public nuisance,
- The protection of children from harm.

Kind regards

Zekiel Cudjoe
Licensing Officer

Commercial Premises
London Borough of Barnet
8th Floor
2 Bristol Avenue
Colindale
London
NW9 4EW
0208 359 3110



RE (Regional Enterprise) Limited is a joint venture between Capita plc and London Borough of Barnet.
Registered in England 08615172. Registered Office: 17 Rochester Row, London, England SW1P 1QT.

From: Conway, Cllr Sara <Cllr.S.Conway@Barnet.gov.uk>
Sent: 06 December 2022 08:01
To: Cudjoe, Zekiel <Zekiel.Cudjoe@Barnet.gov.uk>
Cc: Gurung, Cllr Kamal <Cllr.K.Gurung@Barnet.gov.uk>; Naqvi, Cllr Ammar <Cllr.A.Naqvi@Barnet.gov.uk>
Subject: Fwd: Variation to a premise Licence - Flavours 218 Burnt Oak Broadway Edgware HA8 OAP LAPRE4/22/67285

Forwarding to you based on Elizabeth's out of office.

Best wishes
Sara

Get [Outlook for Android](#)

From: Conway, Cllr Sara <Cllr.S.Conway@Barnet.gov.uk>
Sent: Tuesday, December 6, 2022 7:57:51 AM
To: Hammond, Elisabeth <Elisabeth.Hammond@Barnet.gov.uk>; Naqvi, Cllr Ammar <Cllr.A.Naqvi@Barnet.gov.uk>; Gurung, Cllr Kamal <Cllr.K.Gurung@Barnet.gov.uk>
Subject: Re: Variation to a premise Licence - Flavours 218 Burnt Oak Broadway Edgware HA8 OAP LAPRE4/22/67285

Hi Elizabeth

We would like to object to this variation to 4am as we do not think it is appropriate given the proximity to residential housing and a care home.

Best wishes
Sara

Get [Outlook for Android](#)

Matters for Decision

MATTERS FOR DECISION

Flavours 218 burnt Oak Broadway Edgware HA8 0AP

To allow the Supply of Alcohol - for on sales

Standard Days and Timings On sales

Day	Proposed start time	Proposed finish time	Granted as application	Amended to:	Refused
Monday	10:00hrs	03:30hrs			
Tuesday	10:00hrs	03:30hrs			
Wednesday	10:00hrs	03:30hrs			
Thursday	10:00hrs	03:30hrs			
Friday	10:00hrs	03:30hrs			
Saturday	10:00hrs	03:30hrs			
Sunday	10:00hrs	03:30hrs			

Added conditions, if any:

Reasons for decisions above:

The Performance of live music

Day	Proposed start time	Proposed finish time	Granted as application	Amended to:	Refused
Monday	10:00hrs	04:00hrs			
Tuesday	10:00hrs	04:00hrs			
Wednesday	10:00hrs	04:00hrs			
Thursday	10:00hrs	04:00hrs			
Friday	10:00hrs	04:00hrs			
Saturday	10:00hrs	04:00hrs			
Sunday	10:00hrs	04:00hrs			

Added conditions, if any:

Reasons for decisions above:

The Playing of recorded music - Both indoors and outdoors

Day	Proposed start time	Proposed finish time	Granted as application	Amended to:	Refused
Monday	10:00hrs	04:00hrs			
Tuesday	10:00hrs	04:00hrs			
Wednesday	10:00hrs	04:00hrs			
Thursday	10:00hrs	04:00hrs			
Friday	10:00hrs	04:00hrs			
Saturday	10:00hrs	04:00hrs			
Sunday	10:00hrs	04:00hrs			

Added conditions, if any:

Reasons for decisions above:

The Performance of dance - Both indoors and outdoors

Day	Proposed start time	Proposed finish time	Granted as application	Amended to:	Refused
Monday	10:00hrs	04:00hrs			
Tuesday	10:00hrs	04:00hrs			
Wednesday	10:00hrs	04:00hrs			
Thursday	10:00hrs	04:00hrs			
Friday	10:00hrs	04:00hrs			
Saturday	10:00hrs	04:00hrs			
Sunday	10:00hrs	04:00hrs			

Added conditions, if any:

Reasons for decisions above:

The Provision of late night refreshment - Both indoors and outdoors

Day	Proposed start time	Proposed finish time	Granted as application	Amended to:	Refused
Monday	10:00hrs	04:00hrs			
Tuesday	10:00hrs	04:00hrs			
Wednesday	10:00hrs	04:00hrs			
Thursday	10:00hrs	04:00hrs			
Friday	10:00hrs	04:00hrs			
Saturday	10:00hrs	04:00hrs			
Sunday	10:00hrs	04:00hrs			

Added conditions, if any:

Reasons for decisions above:

Anything of a Similar Description to that falling within definition of Performance of live music, The Playing of recorded music and The Performance of dance.

Day	Proposed start time	Proposed finish time	Granted as application	Amended to:	Refused
Monday	10:00hrs	04:00hrs			
Tuesday	10:00hrs	04:00hrs			
Wednesday	10:00hrs	04:00hrs			
Thursday	10:00hrs	04:00hrs			
Friday	10:00hrs	04:00hrs			
Saturday	10:00hrs	04:00hrs			
Sunday	10:00hrs	04:00hrs			

Added conditions, if any:

Reasons for decisions above:

Open to the Public

Day	Proposed start time	Proposed finish time	Granted as application	Amended to:	Refused
Monday	10:00hrs	04:00hrs			
Tuesday	10:00hrs	04:00hrs			
Wednesday	10:00hrs	04:00hrs			
Thursday	10:00hrs	04:00hrs			
Friday	10:00hrs	04:00hrs			
Saturday	10:00hrs	04:00hrs			
Sunday	10:00hrs	04:00hrs			

Added conditions, if any:

Reasons for decisions above: